

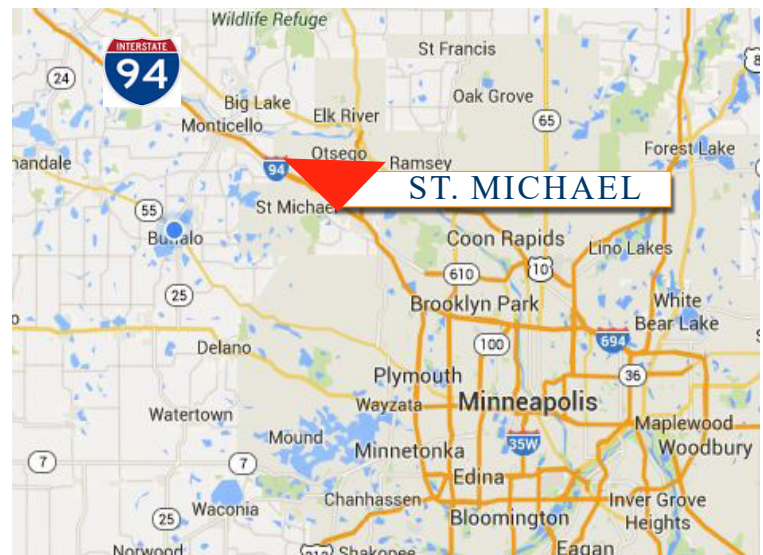

## **PROPERTY INFORMATION**

- \* Lease Rate: **\$12.00/psf (Gross)**  
(Gross Lease Includes: Tax, CAM, Utilities)
- \* Building is 98,331/sf
- \* Available: 6-8,000/sf Warehouse Bay
- \* Built 1999
- \* Wright County PID 114-164-001010
- \* Zoning: I-1 Industrial
- \* Businesses in the Area Include:  
JB Meats, US Water, McDonald's, Cub Foods,  
Pellco Machine, Holiday, Marketplace Foods,  
Allina Clinic, Fastenal, RA Cabinetry, Starbucks,  
Chipotle and more.



**Contact:**  
**JOE ELAM**  
**(320) 282-8410**  
**JElam@crs-mn.com**



COMMERCIAL REALTY SOLUTIONS

# For Lease Industrial Bay 12070 43rd St, St. Michael 55376

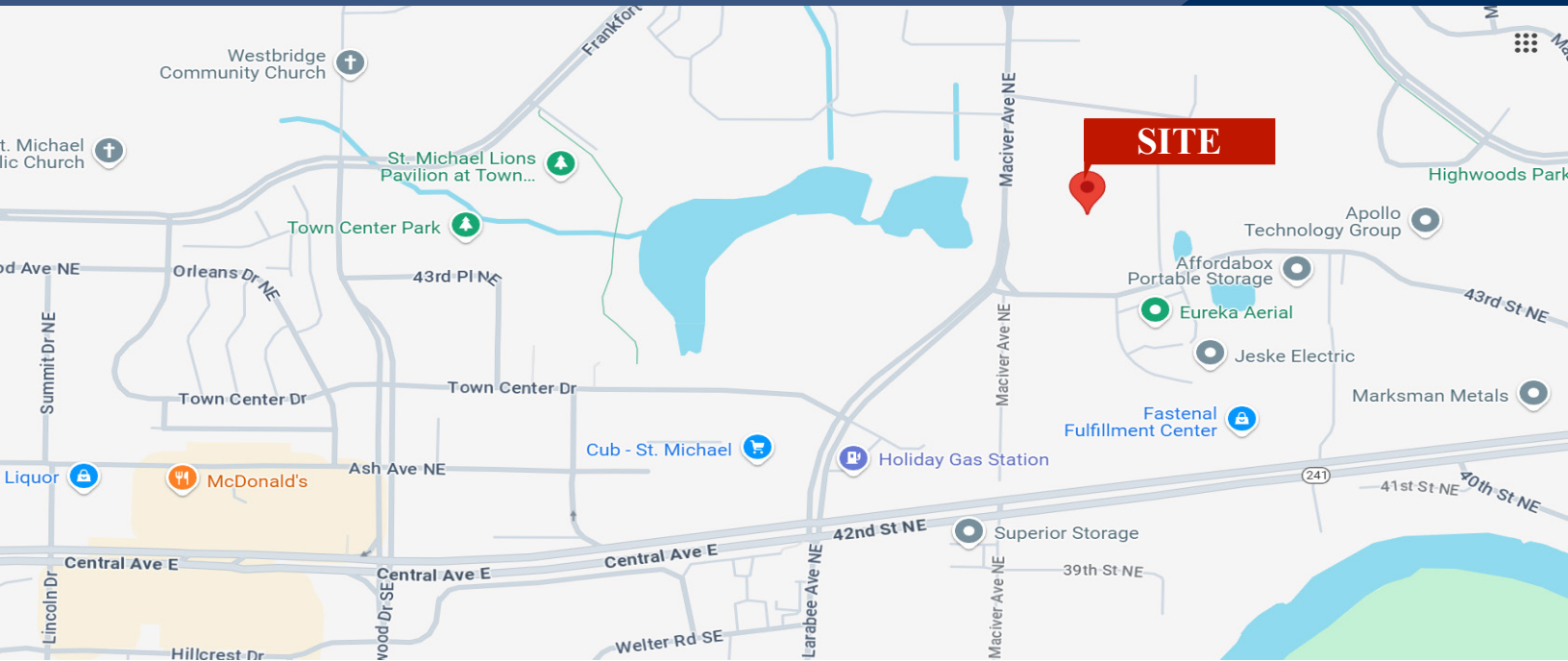

## PROPERTY INFORMATION

- \* 2 Miles from I-94
- \* North of Highway 241
- \* Easy Access to I-94
- \* Great Location



## TRAFFIC COUNTS - 2024

- \* County Road 241 - 25,896 VPD
- \* Maciver Ave NE - 4,971 VPD

**Contact:**  
**JOE ELAM**  
**(320) 282-8410**  
**JElam@crs-mn.com**

3 Highway 55 West, Buffalo, MN 55313-4320 | 763-682-2400 | info@crs-mn.com

The information contained herein was obtained from sources believed to be reliable, but Commercial Realty Solutions has not verified nor has any knowledge regarding the accuracy of information and makes no representation or warranty concerning the same. Therefore, Commercial Realty Solutions disclaims all liabilities in connection with any inaccuracies or incompleteness. This marketing material is for the implicit use by Commercial Realty Solutions for the marketing of their listings and is not for use by other brokerage(s).





COMMERCIAL REALTY SOLUTIONS

# For Lease Industrial Bay 12070 43rd St, St. Michael 55376

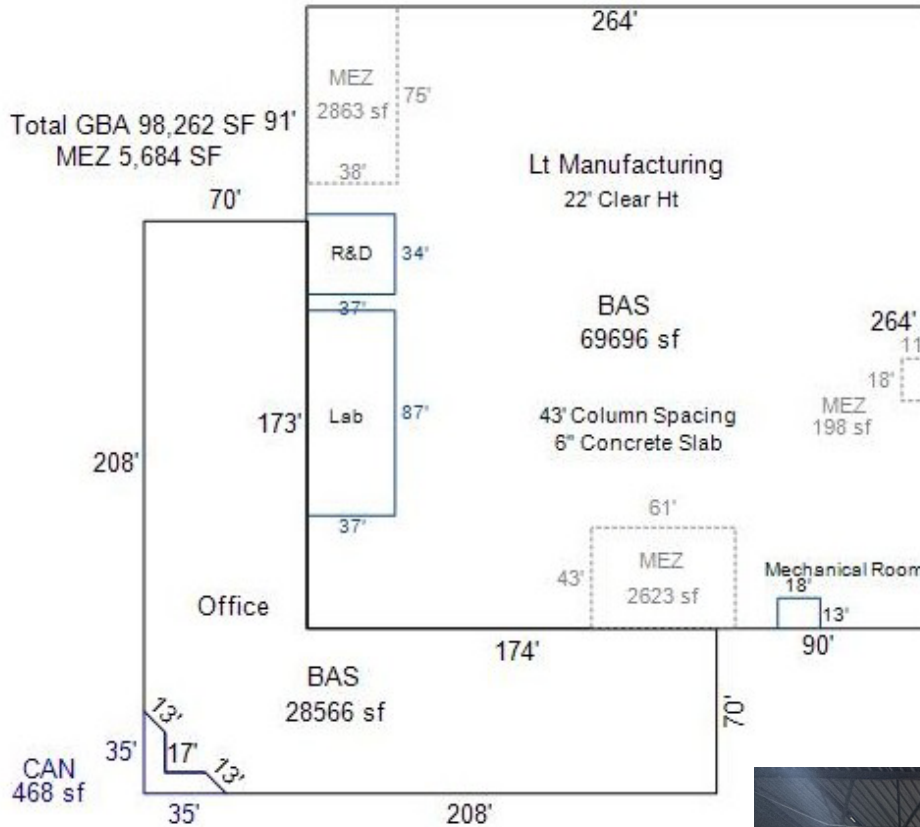

## BUILDING INFORMATION

- \* (1) 12' x 14' O.H. Drive-In Door
- \* Crane System in place
- \* Column Spacing 44' x 44'
- \* T-8 Lighting
- \* Building is Fully Sprinkled
- \* 19'-5" to Bottom of Crane Joists
- \* 23'-7" to Bottom of Bar Joists
- \* Shop Unit Heaters
- \* (1) Loading Dock (Shared)

**Contact:**  
**JOE ELAM**  
**(320) 282-8410**  
**JElam@crs-mn.com**

3 Highway 55 West, Buffalo, MN 55313-4320 | 763-682-2400 | info@crs-mn.com

The information contained herein was obtained from sources believed to be reliable, but Commercial Realty Solutions has not verified nor has any knowledge regarding the accuracy of information and makes no representation or warranty concerning the same. Therefore, Commercial Realty Solutions disclaims all liabilities in connection with any inaccuracies or incompleteness. This marketing material is for the implicit use by Commercial Realty Solutions for the marketing of their listings and is not for use by other brokerage(s).

**For Lease**  
**Industrial Bay**  
**12070 43rd St, St. Michael 55376**



**Contact:**  
**JOE ELAM**  
**(320) 282-8410**  
**[JElam@crs-mn.com](mailto:JElam@crs-mn.com)**

**3 Highway 55 West, Buffalo, MN 55313-4320 | 763-682-2400 | [info@crs-mn.com](mailto:info@crs-mn.com)**

The information contained herein was obtained from sources believed to be reliable, but Commercial Realty Solutions has not verified nor has any knowledge regarding the accuracy of information and makes no representation or warranty concerning the same. Therefore, Commercial Realty Solutions disclaims all liabilities in connection with any inaccuracies or incompleteness. This marketing material is for the implicit use by Commercial Realty Solutions for the marketing of their listings and is not for use by other brokerage(s).