



COMMERCIAL REALTY SOLUTIONS

For Lease
Retail / Office



**Ready for Build-Out
Summer 2025**

ALBERTVILLE

Retail / Office

Lease Rate: \$25.00/psf NNN

Building Size: 7,562/sf Available: 2,425/sf

5292 Kyler Ave NE, Albertville, MN 55301

Sheila Zachman, Broker
763.244.0600
SZachman@crs-mn.com

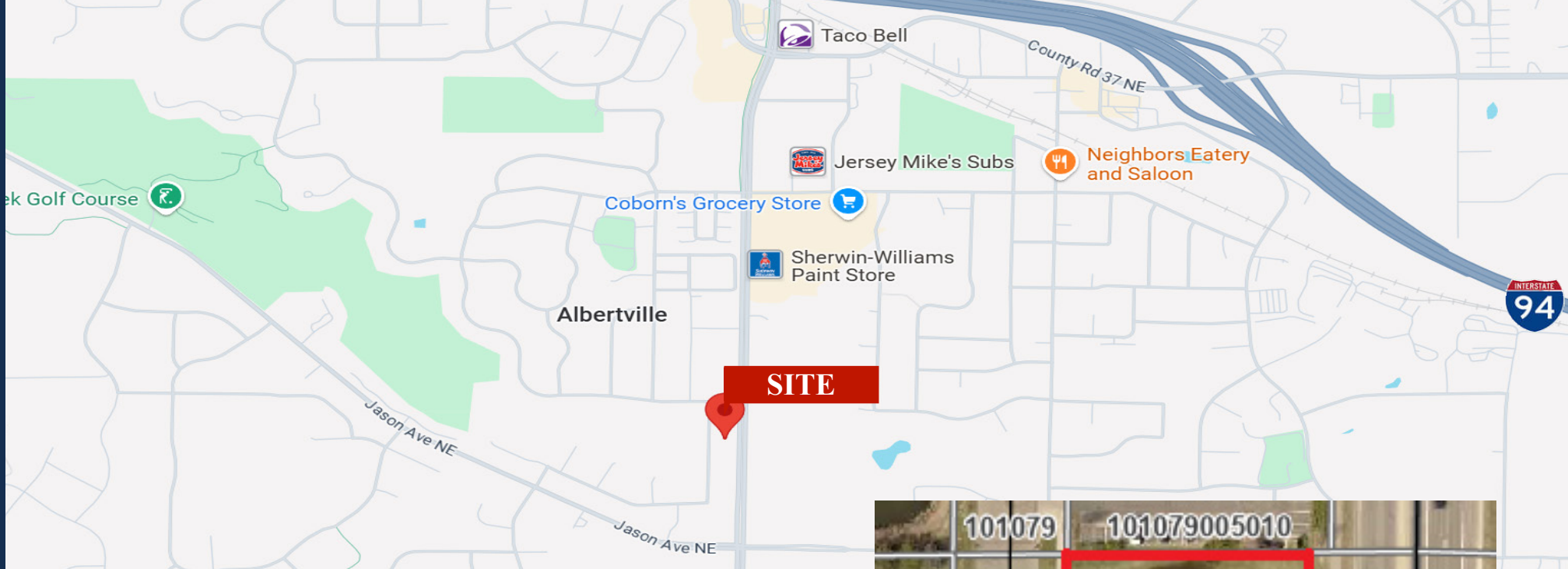

PROPERTY LOCATION

- * South of I-94
- * West of Labeaux
- * South of 53rd Street
- * Businesses in the Area:

Si Senor Mexican Restaurant, Hen & Hog Restaurant, Coborn's, Sister Kenny Sports & Physical Therapy, Mathnasium, Casey's, Albertville Orthodontics, Farrell's Extreme Bodyshaping, Sherwin Williams, STMA Middle School West, and more.

TRAFFIC COUNTS - 2023

- * I-94 - 58,540 VPD
- * Labeaux Ave- 17,517 VPD
- * 53rd Street - 1,792 VPD



The information contained herein was obtained from sources believed to be reliable, but Commercial Realty Solutions has not verified nor has any knowledge regarding the accuracy of information and makes no representation or warranty concerning the same. Therefore, Commercial Realty Solutions disclaims all liabilities in connection with any inaccuracies or incompleteness. This marketing material is for the implicit use by Commercial Realty Solutions for the marketing of their listings and is not for use by other brokerage(s).

PROPERTY OVERVIEW

Lease Rate

\$25.00/psf NNN

Operating Expense	\$8.00/psf
Building Size	7,562/sf
Space Available	2,425/sf
County	Wright
PID	101-137-001010
2024 Taxes	\$9,044.00
Zoned	B-2, Limited Business
Year Built	New Construction Available Summer 2025



BUILDING INFORMATION

- * Concrete Floor
- * HVAC Unit
- * Plumbing for One (1) Bathroom
- * Landlord will take to studs (ready for build-out)

This information has been secured from sources we believe to be reliable, but we make no representations or warranties explained or implied as to the accuracy of the information. Buyer must verify the information and bears all risk for any inaccuracies.

TENANT SPACE FLOOR PLAN

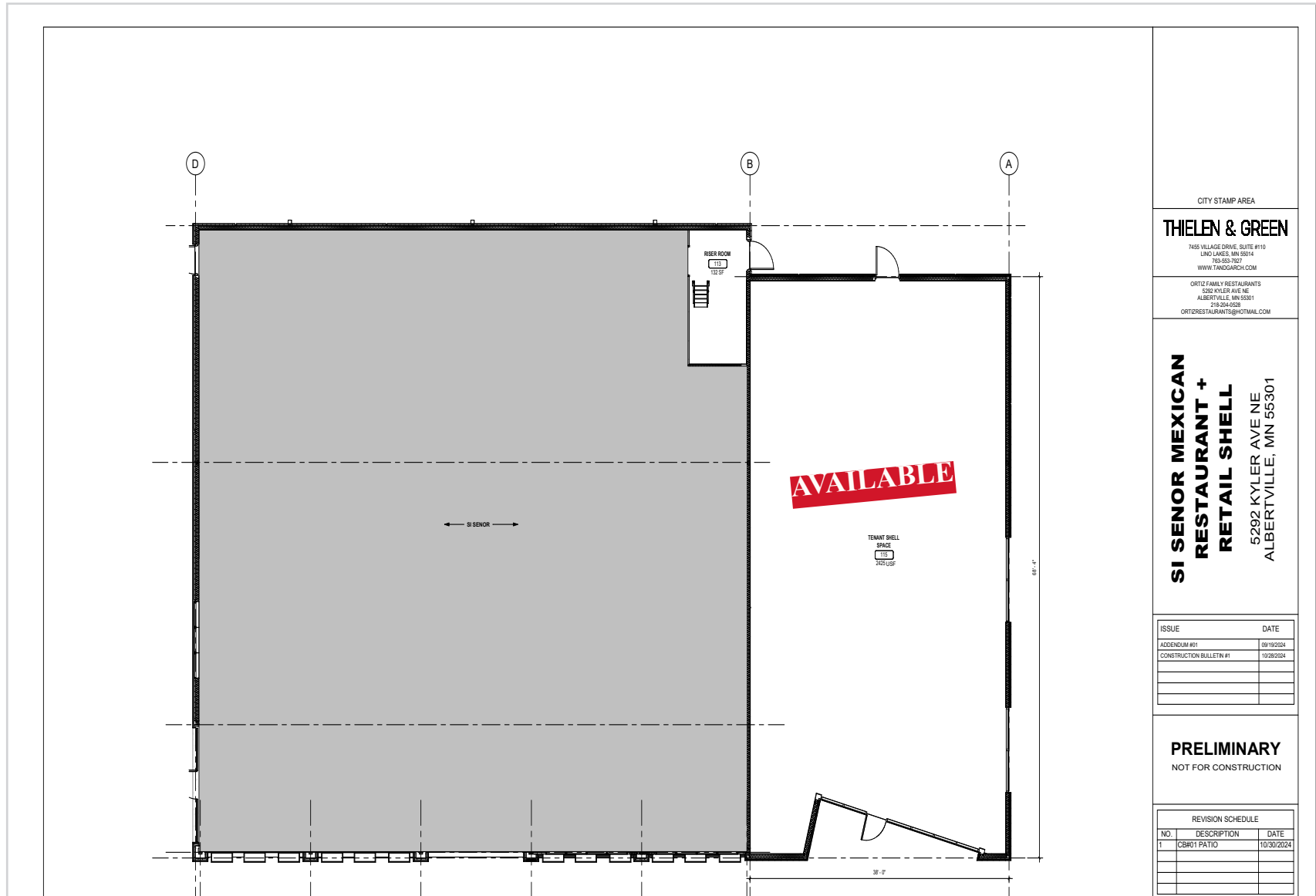

CITY STAMP AREA

THIELEN & GREEN
 7455 VILLAGE DRIVE, SUITE #110
 LIND LAKES, MN 55114
 763-653-7927
 WWW.TANDGARCH.COM

ORTIZ FAMILY RESTAURANTS
 5292 KYLER AVE NE
 ALBERTVILLE, MN 55301
 218-244-6258
 ORTIZRESTAURANTS@HOTMAIL.COM

**SI SENOR MEXICAN
 RESTAURANT +
 RETAIL SHELL**
 5292 KYLER AVE NE
 ALBERTVILLE, MN 55301

ISSUE	DATE
ADDENDUM #1	09/19/2024
CONSTRUCTION BULLETIN #1	10/28/2024

PRELIMINARY
 NOT FOR CONSTRUCTION

REVISION SCHEDULE		
NO.	DESCRIPTION	DATE
1	CB#01 PATIO	10/30/2024

This information has been secured from sources we believe to be reliable, but we make no representations or warranties explained or implied as to the accuracy of the information. Buyer must verify the information and bears all risk for any inaccuracies.

CONCEPTUAL DRAWING - EXTERIOR



AREA INFORMATION

- * Albertville population growth is 5.7% annually
- * Median Income \$126,307
- * Median Age is 37.4 years old
- * Population 9,465



This information has been secured from sources we believe to be reliable, but we make no representations or warranties explained or implied as to the accuracy of the information. Buyer must verify the information and bears all risk for any inaccuracies.